

# AX10X WET VAC TOOL PARTS

Part #	Description	QTY
AX10X	GEKKO 14" WET VAC TOOL	1
AR51X	Gekko Wet Vac Handle	1
AR51V	Gekko 14" Squeegee Wet Vac Squeegee Head	1

AR51X - Gekko Wet Vac Handle Assembly: Pages 2-4

AR51V - Gekko 14" Squeegee Wet Vac Squeegee Head Assembly: Pages 5-7



# AX10X WET VAC TOOL PARTS

Part #	Description	QTY
AR51X	Gekko Wet Vac Handle	1
NA030	Gekko Wand Tube with bracket	1
NA030A	Vent Slide	1
NM5855	Gekko Tool Coupler Assembly	1
NM4080	10-32 x 1 5/8" Screw	3
NM4028	10-32 Hex Nut Zinc Plated	3
NA031B	Spray Gun Body – No valve	1
NM5629	Screw 4mm x 20 PPH Self tap Black	4
NM5858	Gekko Grip Handle Assembly (Includes mounting screws & nuts)	1



GEKKO WET VAC HANDLE  
AR51X

# AX10X WET VAC TOOL PARTS

Spray Gun Body NA031B – Without screws - Modified for mounting.

- Install four screws NM5629 into the holes near the back of the plastic body.
- Drill three 3/16" holes all the way through plastic body in the three holes near the front of the plastic body.

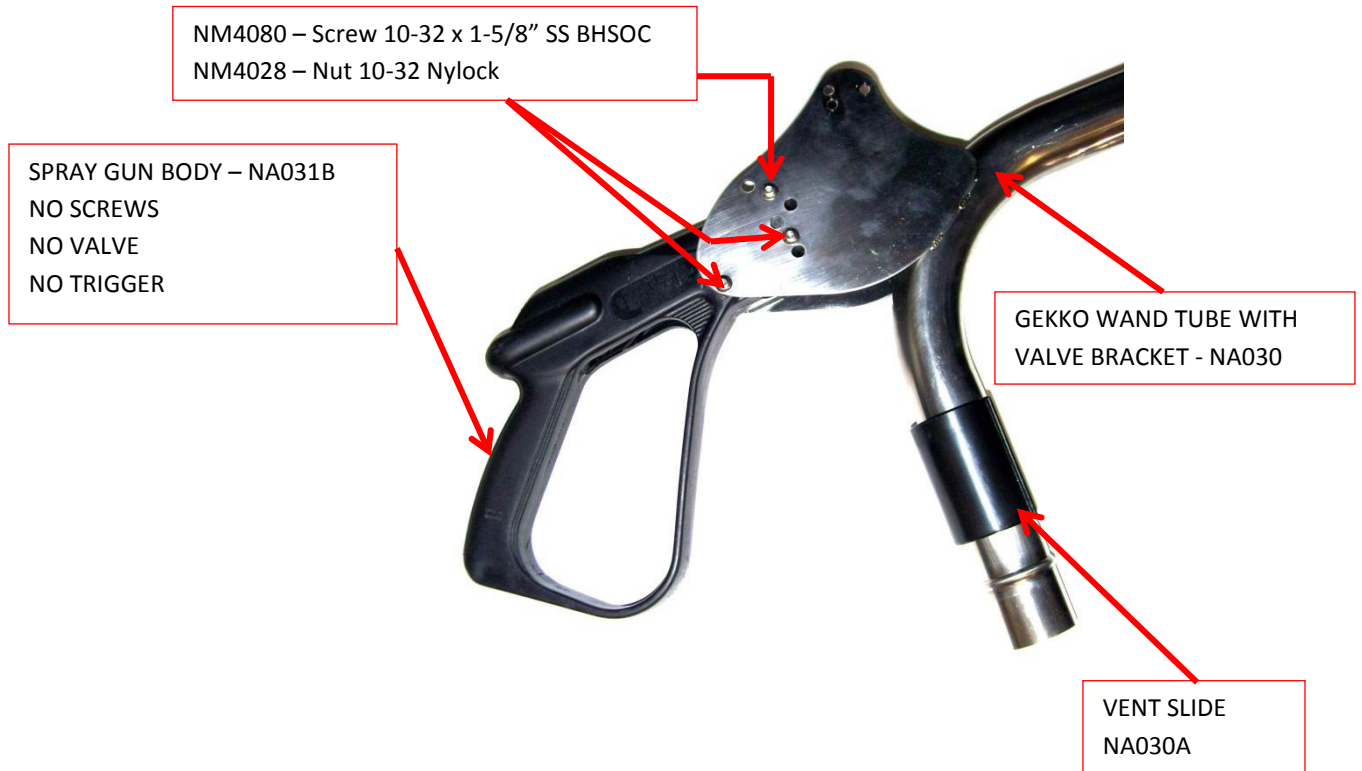

# AX10X WET VAC TOOL PARTS

## Gekko Tool Coupler Assembly NM5855

Includes both sides of coupler and two 8-32 x 7/16" Phillips Pan Head Screws

APPLY GREASE HERE

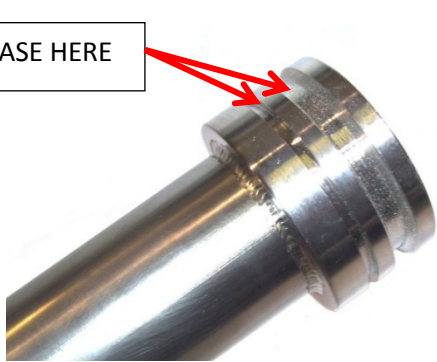

Left Coupler



Right Coupler



8-32 x 7/16" Phillips Pan Head Screws



Gekko Tool Coupler Assembly  
Installed on Wand Tube

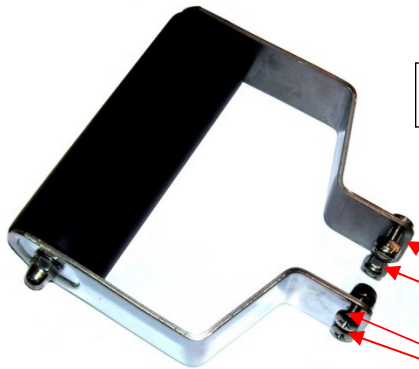

NM5858 Gekko Grip Handle Assembly

NM5698 – Screw 10-32 x 1/2" PPH SS  
NM4028 – Nut 10-32 Nylock

# AX10X WET VAC TOOL PARTS

Part #	Description	QTY
AR51V	Gekko 14" Squeegee Wet Vac Squeegee Head	1
NA021A	Cast 14" Gekko Head	1
AR51SQ	Attachment Gekko 14" Squeegee	1
BR218	Plug 1/8" MPT Socket Head Brass	5
BR219	Plug 1/4" MPT Socket Head Brass	2
NM5852	4-40 x 0.3125" Pan Head Machine Screw, SS	5



AR51V - 14" GEKKO WET VAC SQUEEGEE HEAD

# AX10X WET VAC TOOL PARTS

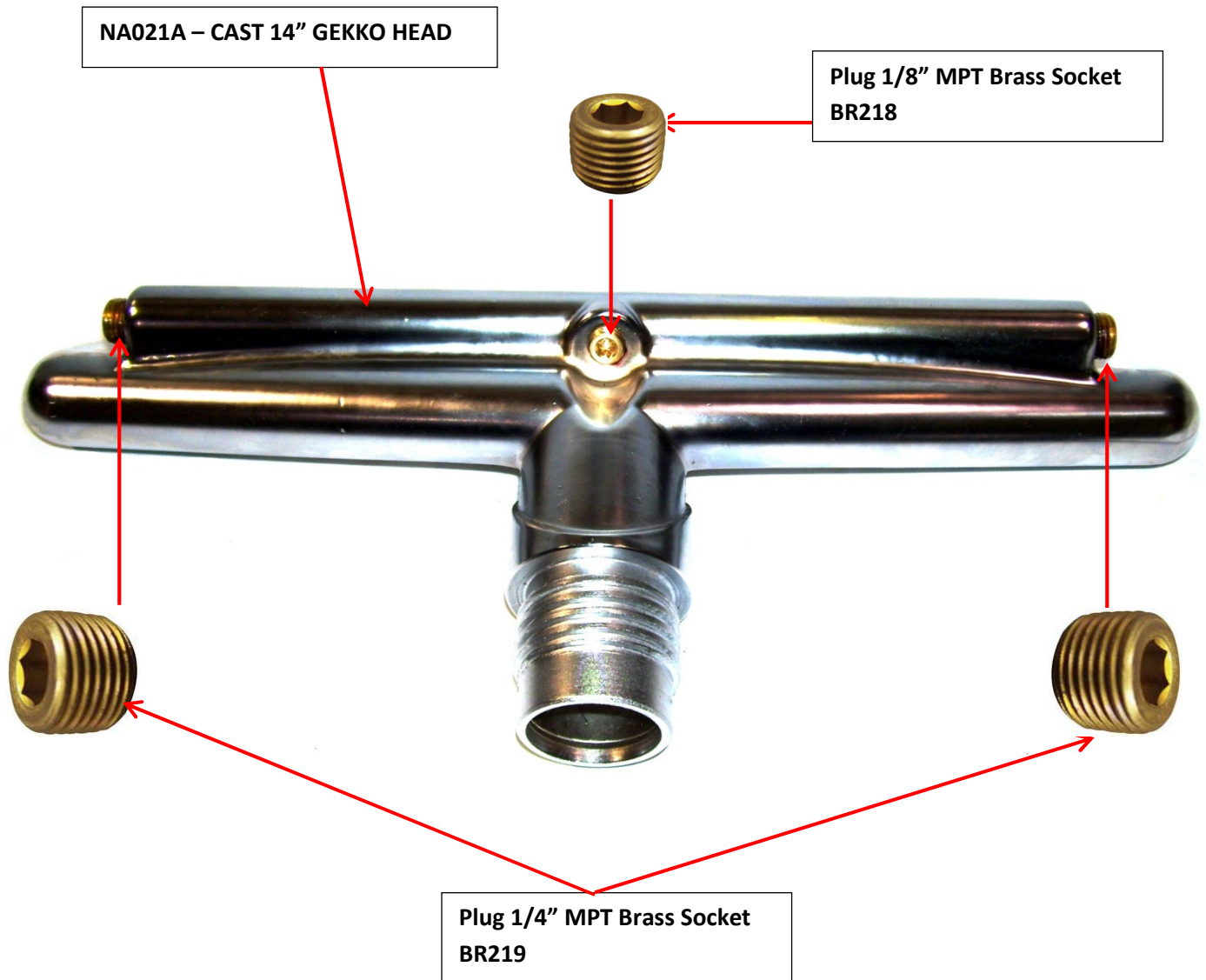

# AX10X WET VAC TOOL PARTS

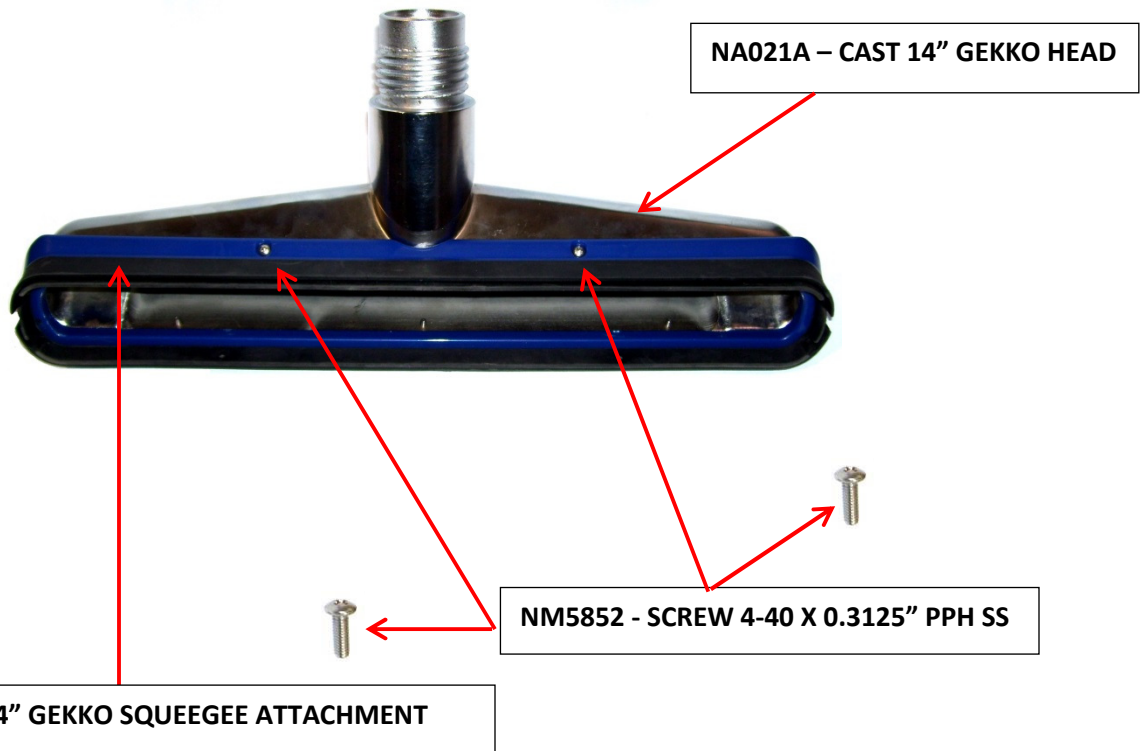
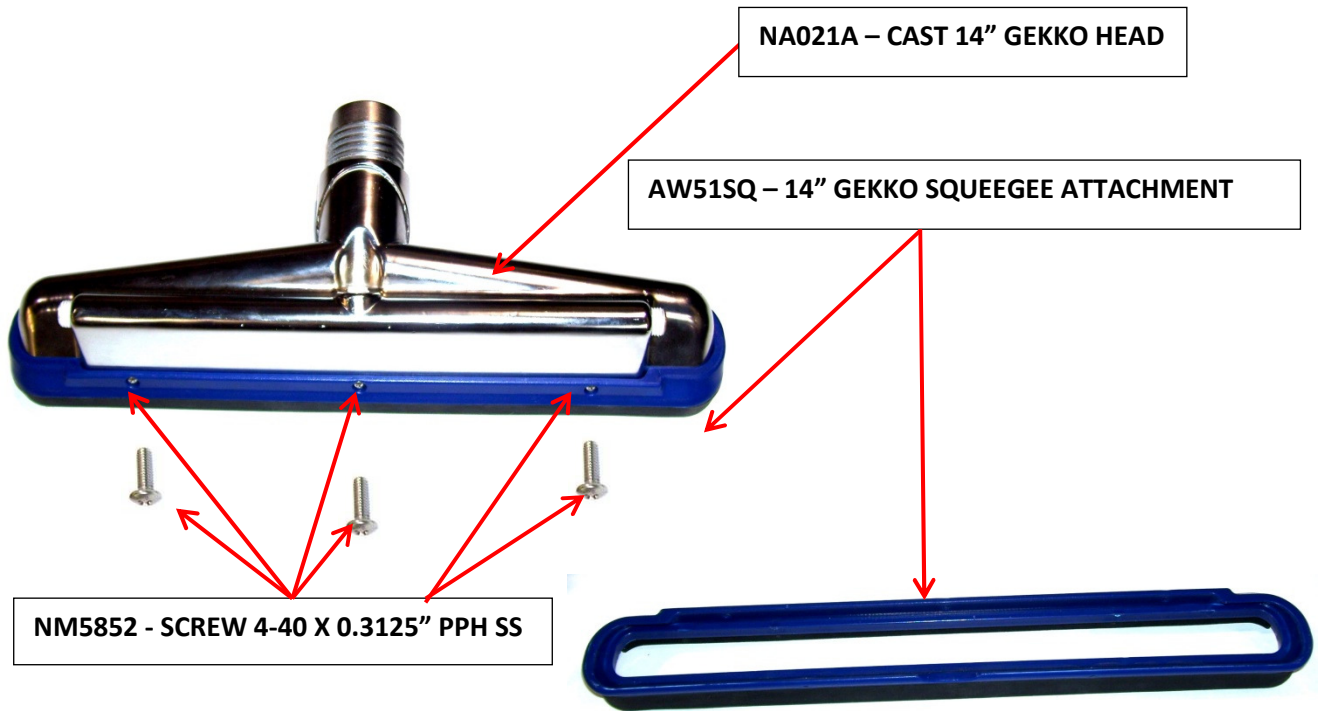

# AX10X WET VAC TOOL PARTS

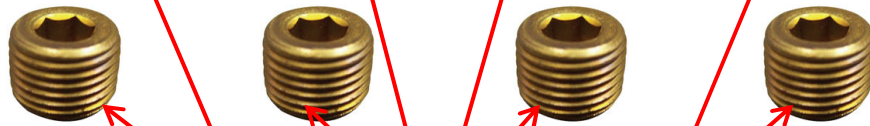
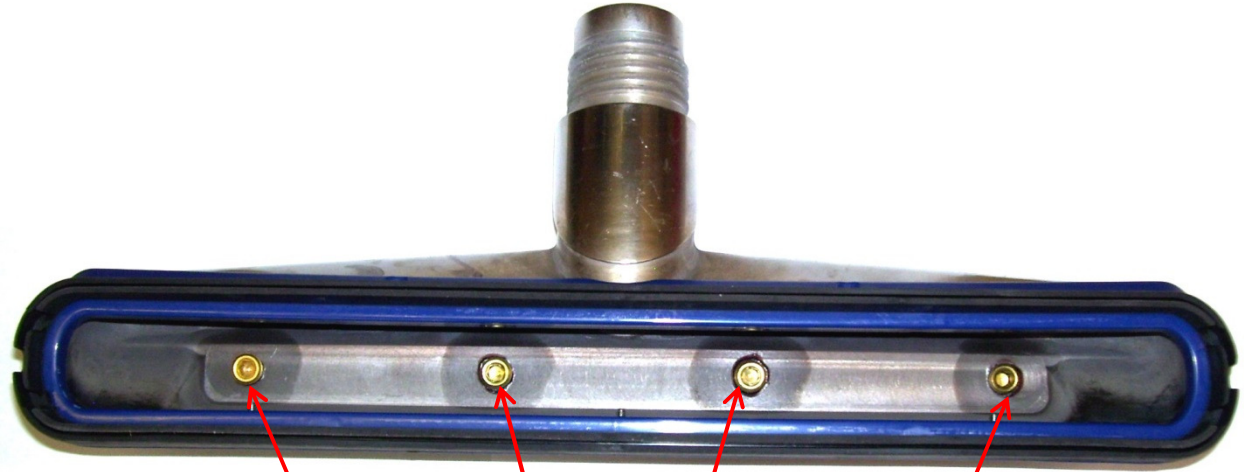

**Plug 1/8" MPT Brass Socket  
BR218**